

**zone a defricher**

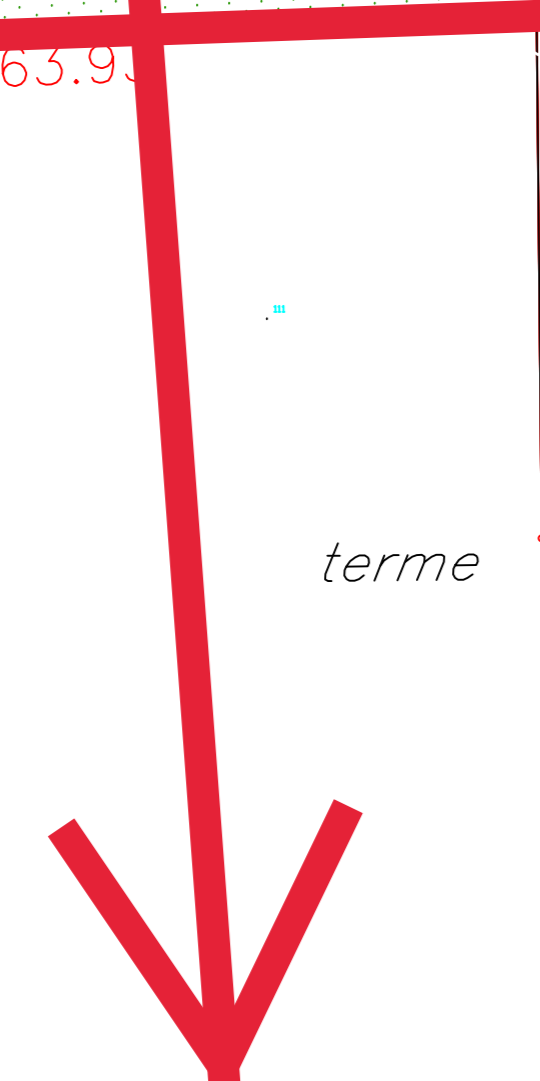

**Zone Ai**  
S=19247m2

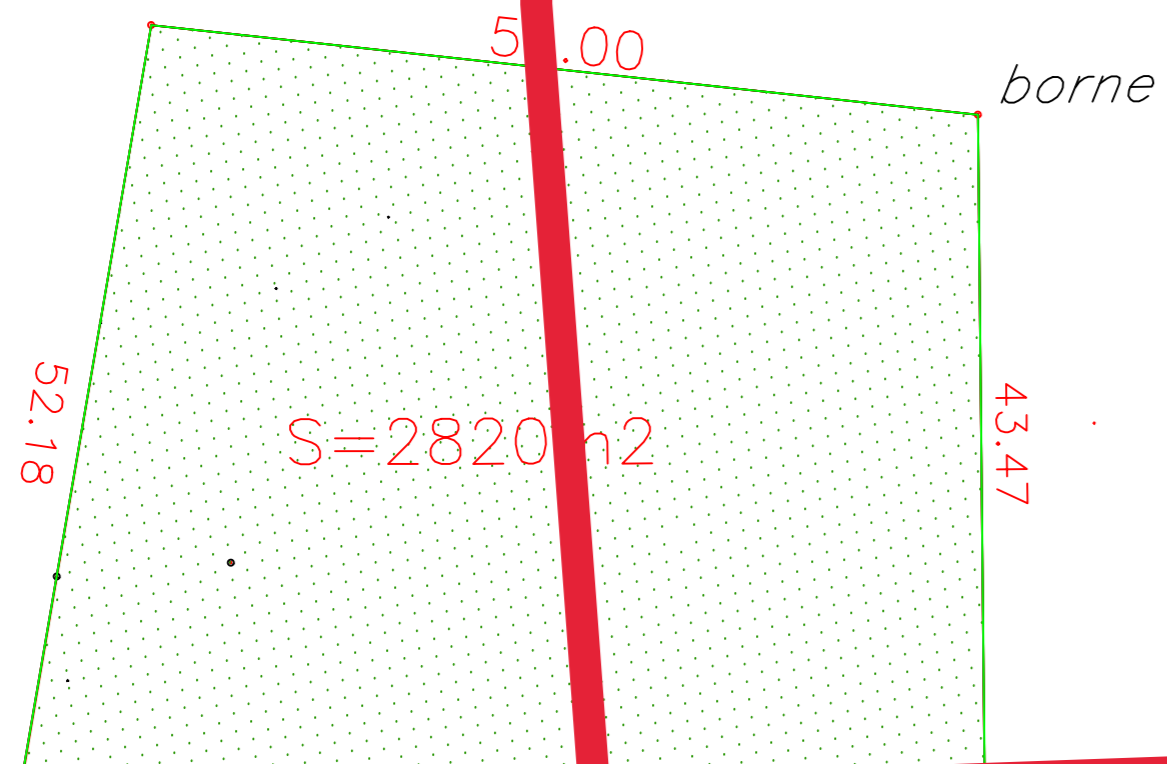
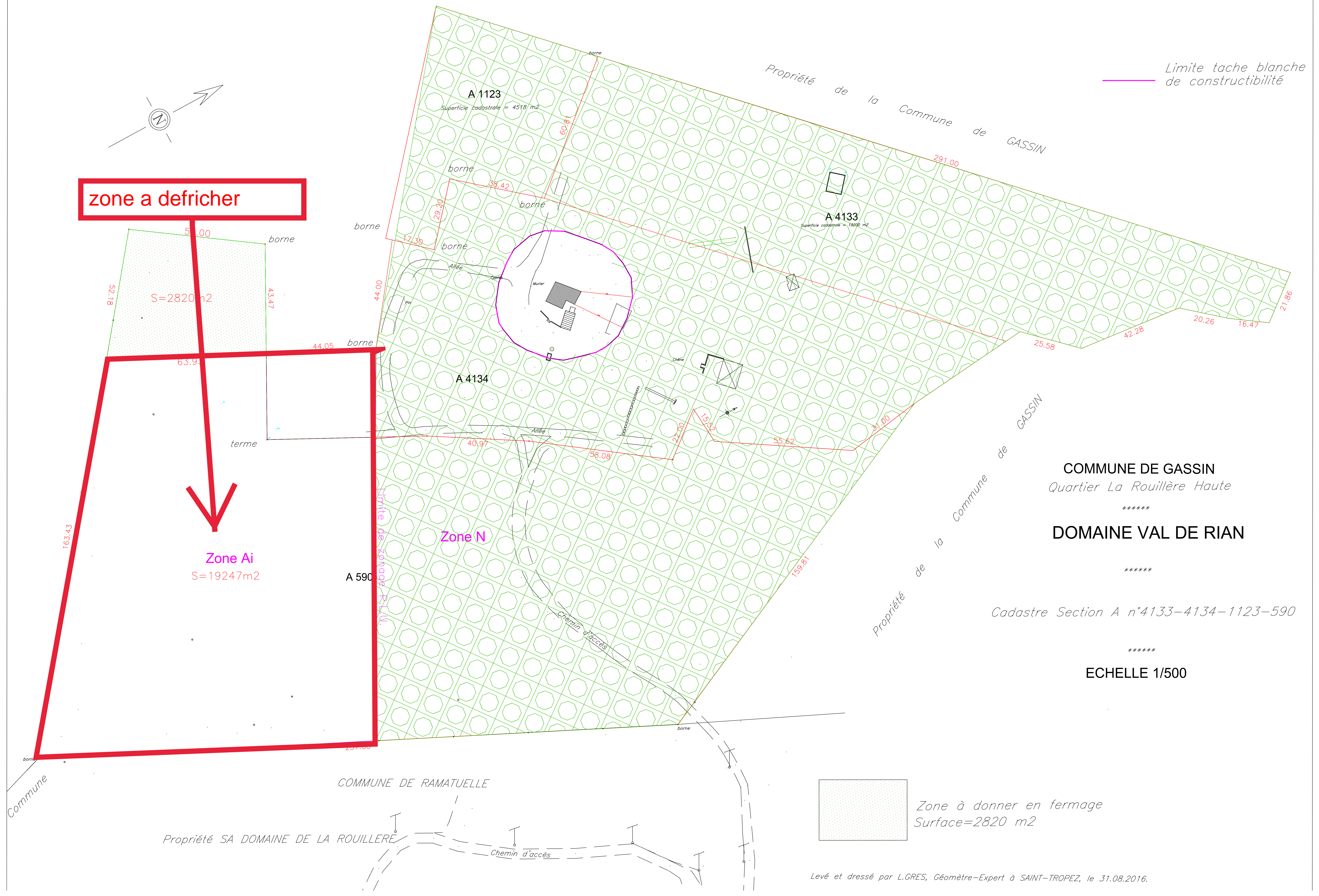

— Limite tache blanche de constructibilité

**COMMUNE DE GASSIN**  
Quartier La Rouillère Haute

**DOMAINE VAL DE RIAN**

Cadastre Section A n°4133-4134-1123-590

**ECHELLE 1/500**

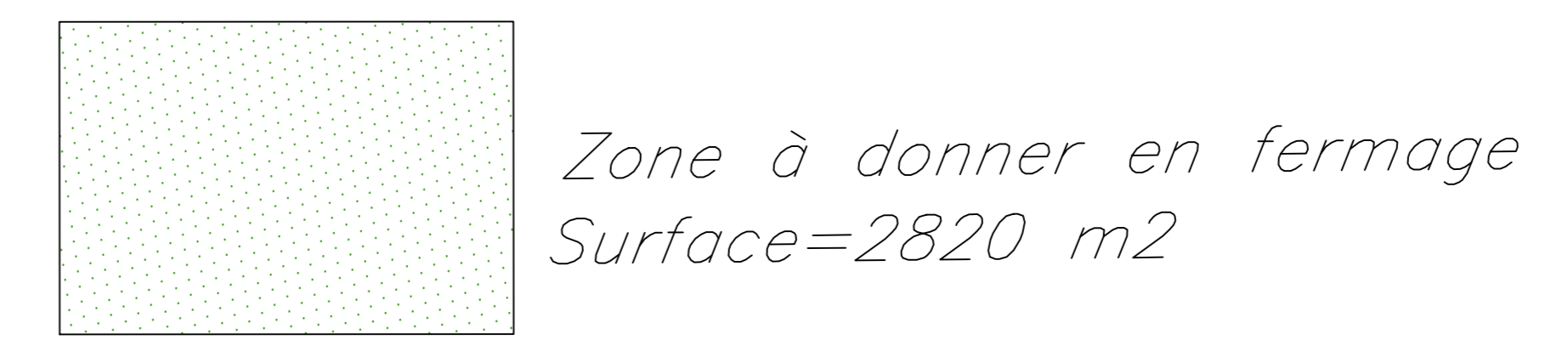

Levé et dressé par L.GRES, Géomètre-Expert à SAINT-TROPEZ, le 31.08.2016.