

PLAN DE SITUATION

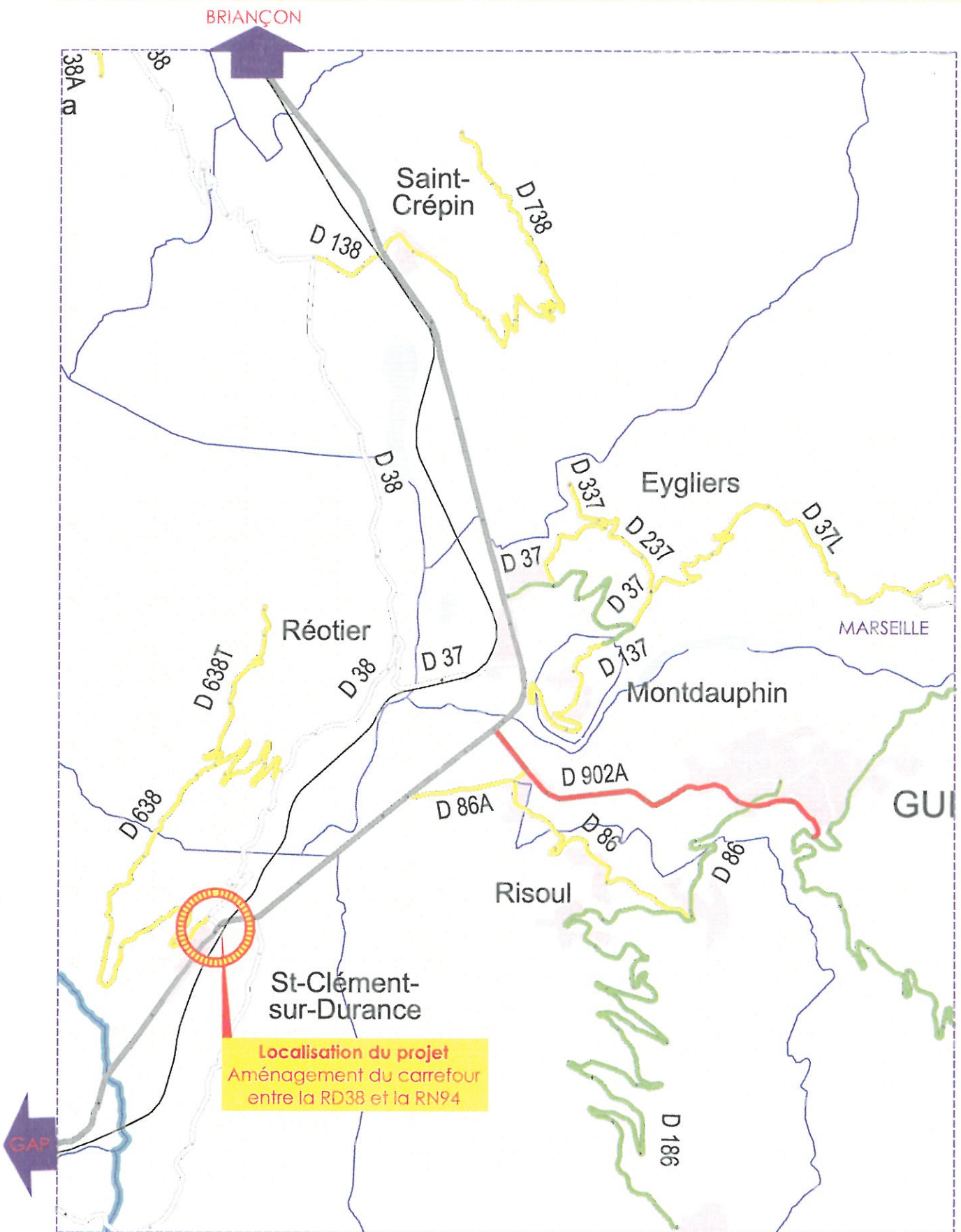

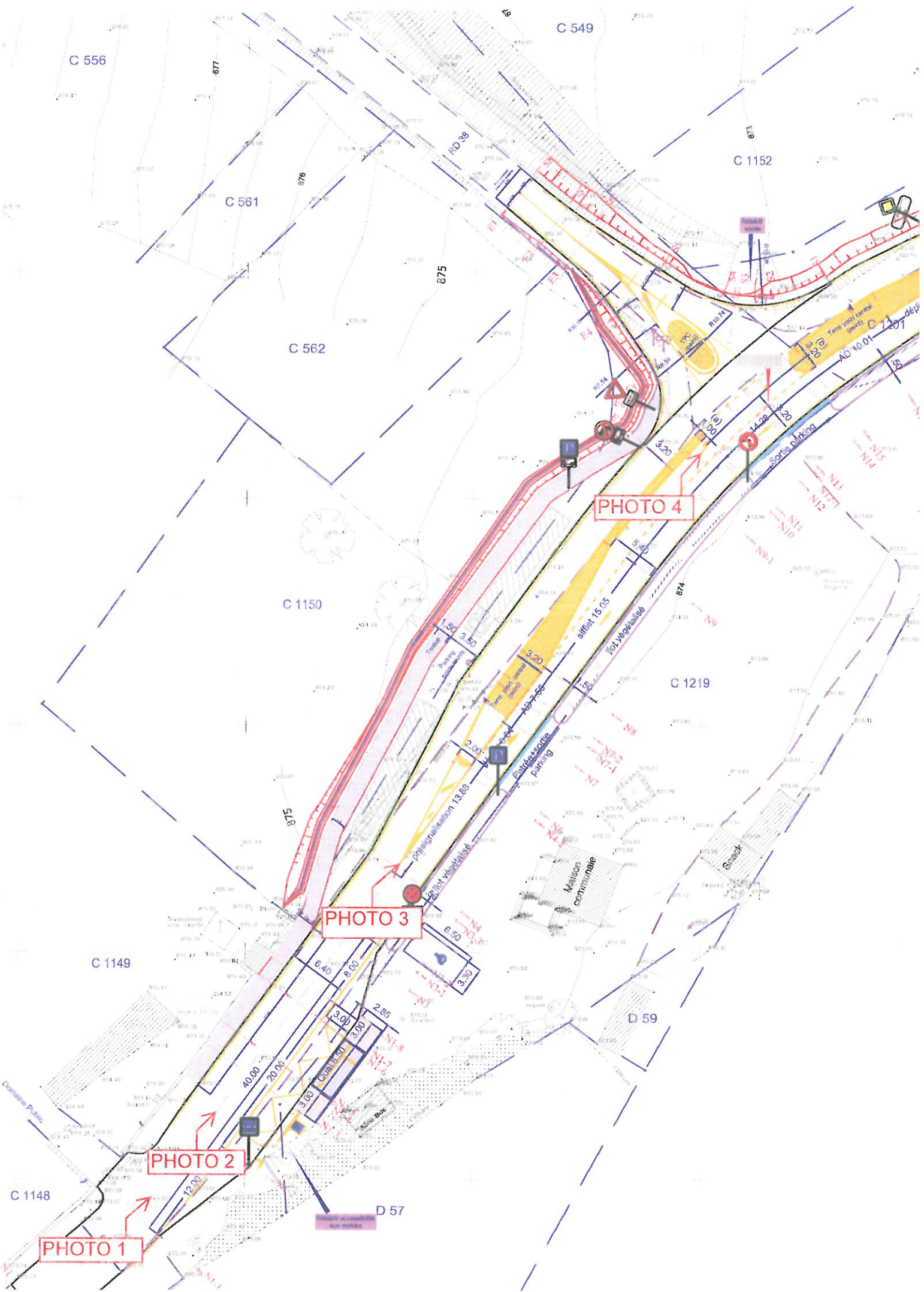

PHOTO 1

PHOTO 2

PHOTO 3

PHOTO 4

C 556

C 549

C 561

C 1152

C 562

C 1150

C 1219

C 1149

D 59

C 1148

D 57

RD 38

RD 74

AD 10 01

AD 13 88

AD 13 86

12.00

40.00

20.00

3.00

3.90

3.90

6.40

9.00

2.85

1.50

3.50

5.20

3.20

5.40

3.20

14.20

2.20

875

875

874

874

877

876

873

875

NK-1

NK-2

NK-3

NK-4

NK-5

NK-6

NK-7

NK-8

NK-9

NK-10

NK-11

NK-12

NK-13

NK-14

NK-15

13.88

15.05

5.20

3.20

5.40

3.20

14.20

2.20

3.20

5.40

3.20

5.40

3.20

14.20

2.20

875

875

875

875

875

875

875

875

875

875

875

875

875

PHOTO 4

PHOTO 3

PHOTO 2

PHOTO 1

13.88

15.05

5.20

3.20

5.40

3.20

14.20

2.20

3.20

5.40

3.20

5.40

3.20

14.20

2.20

875

875

875

875

875

875

875

875

875

875

875

875

875

PHOTO 4

PHOTO 3

PHOTO 2

PHOTO 1

13.88

15.05

5.20

3.20

5.40

3.20

14.20

2.20

3.20

5.40

3.20

5.40

3.20

14.20

2.20

875

875

875

875

875

875

875

875

875

875

875

875

875

PHOTO 4

PHOTO 3

PHOTO 2

PHOTO 1

13.88

15.05

5.20

3.20

5.40

3.20

14.20

2.20

3.20

5.40

3.20

5.40

3.20

14.20

2.20

875

875

875

875

875

875

875

875

875

875

875

875

875

PHOTO 4

PHOTO 3

PHOTO 2

PHOTO 1

13.88

15.05

5.20

3.20

5.40

3.20

14.20

2.20

3.20

5.40

3.20

5.40

3.20

14.20

2.20

875

875

875

875

875

875

875

875

875

875

875

875

875

PHOTO 4

PHOTO 3

PHOTO 2

PHOTO 1

13.88

15.05

5.20

3.20

5.40

3.20

14.20

2.20

3.20

5.40

3.20

5.40

3.20

14.20

2.20

875

875

875

875

875

875

875

875

875

875

875

875

875

PHOTO 4

PHOTO 3

PHOTO 2

PHOTO 1

13.88

15.05

5.20

3.20

5.40

3.20

14.20

2.20

3.20

5.40

3.20

5.40

3.20

14.20

2.20

875

875

875

875

875

875

875

875

875

875

875

875

875

PHOTO 4

PHOTO 3

PHOTO 2

PHOTO 1

13.88

15.05

5.20

3.20

5.40

3.20

14.20

2.20

3.20

5.40

3.20

5.40

3.20

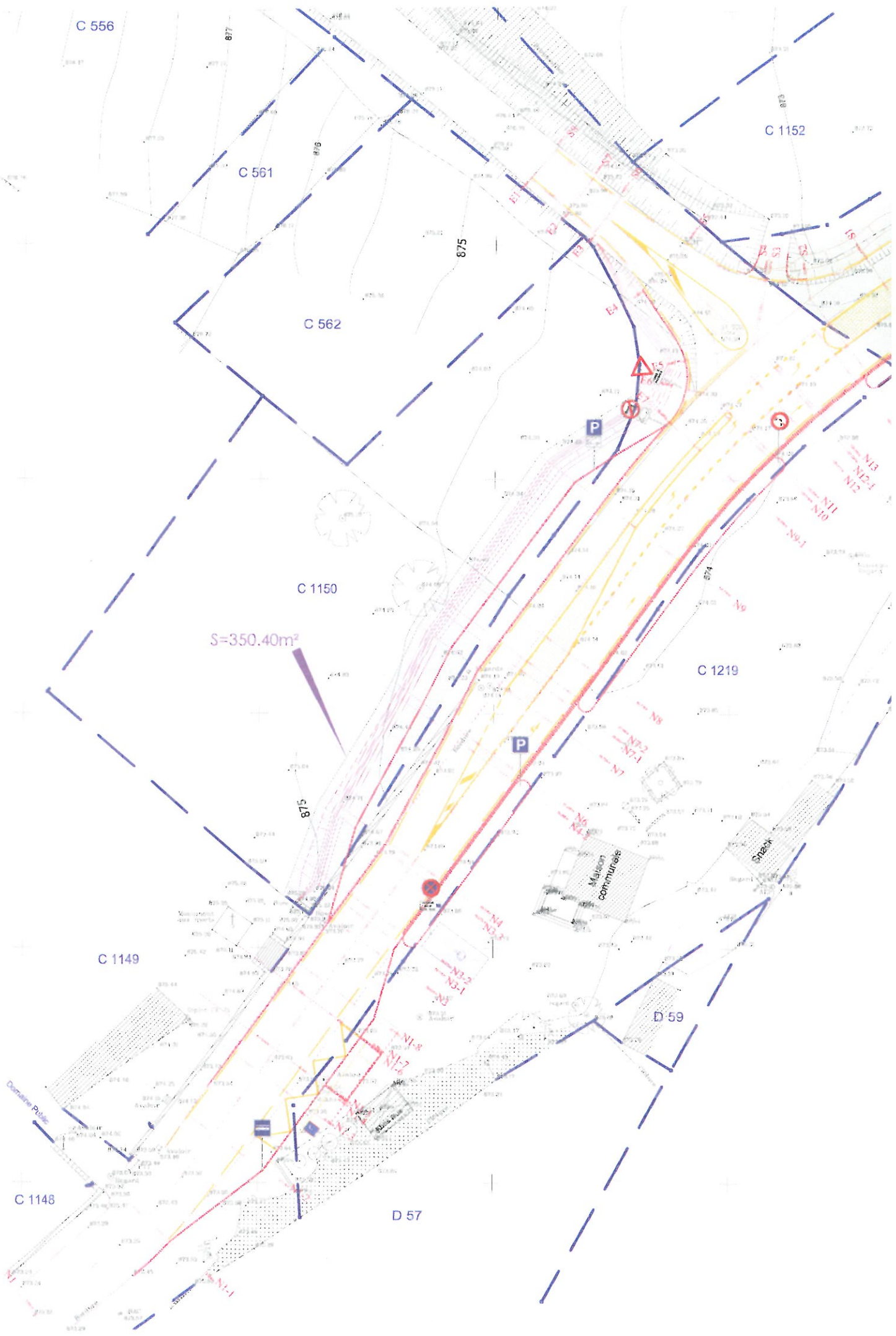

C 556

C 561

C 562

C 1152

C 1150

S=350.40m²

C 1219

C 1149

Maison communale

Shed

D 59

C 1148

D 57